

PLAN VIEW

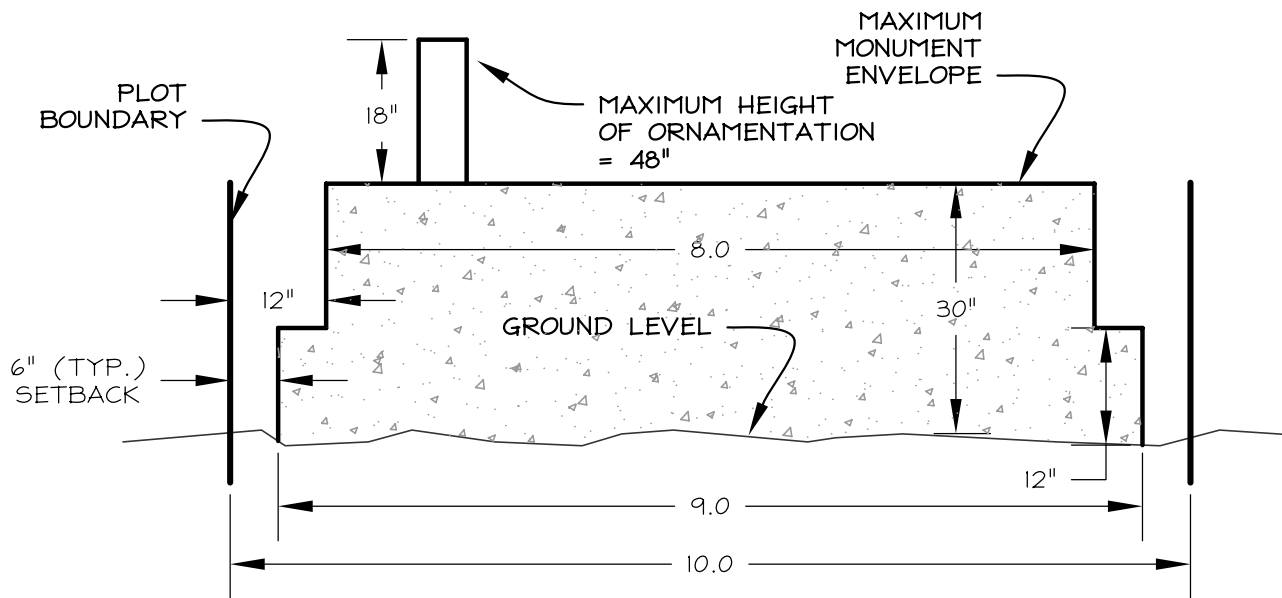

SECTION A-A

Mono County
Department of Public Works

74 North School St.
 Post Office Box 457
 Bridgeport, CA 93517

Phone: (760)932-5440
 Fax: (760)932-5441
 monopw@mono.ca.gov

MONO COUNTY
CEMETERIES
MONUMENT DETAIL

Attachment
 1

DATE: 3/8/07

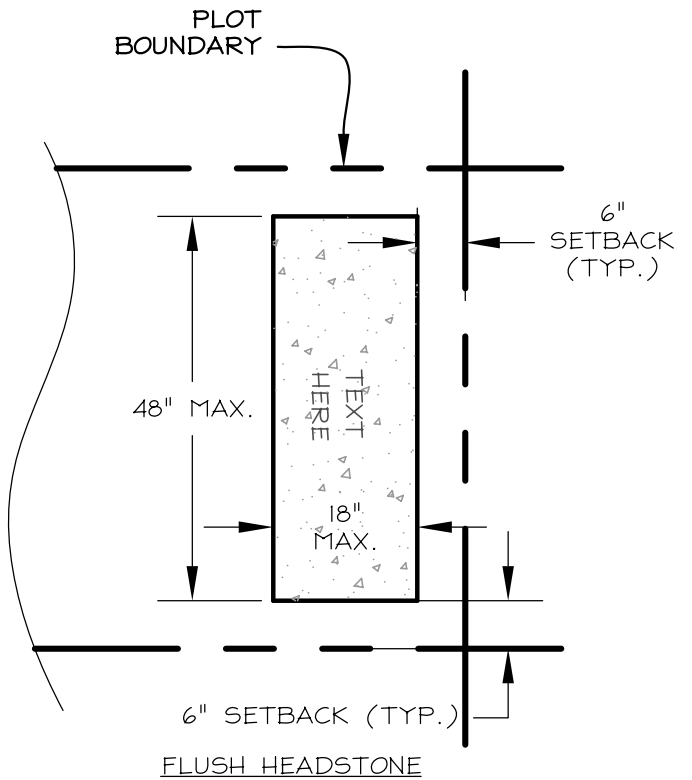
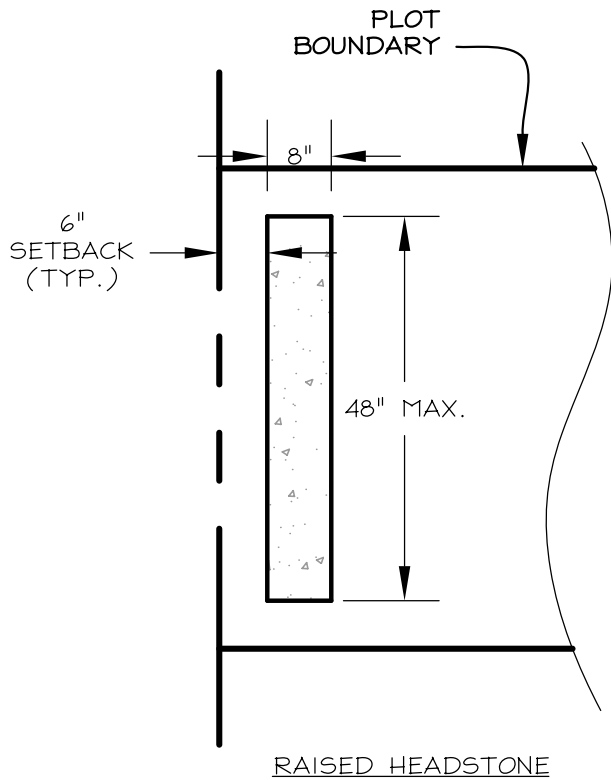

PLAN VIEW

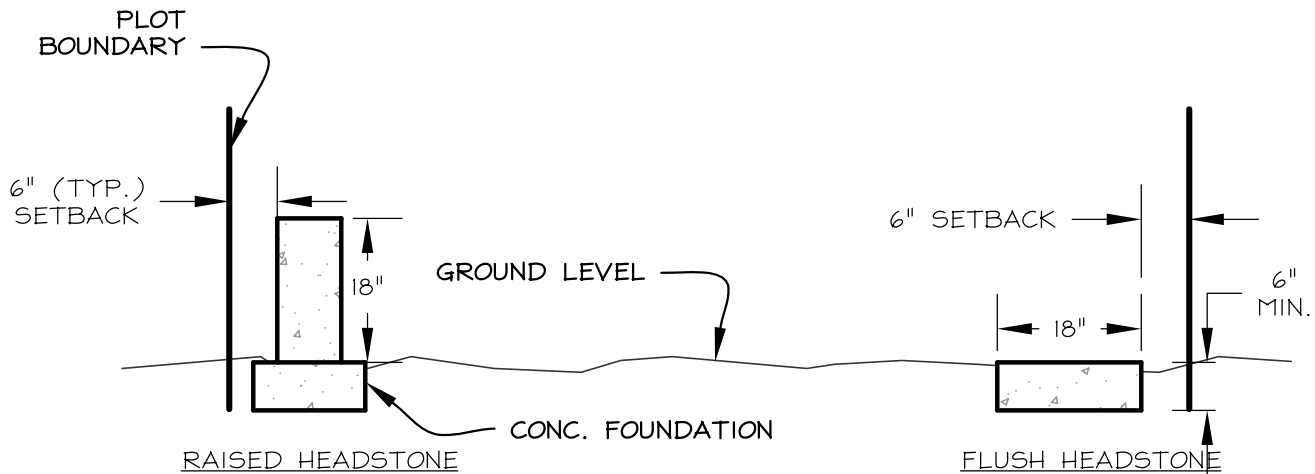

SECTION

NOTES:

1. Headstones shall be a minimum of 12" high and 24" wide (above-ground dimensions).
2. A maximum of two markers are allowed per 5'x10' plot.
3. Markers delivered to cemetery must be inspected and approved by the Dept. of Public Works prior to installation.

Mono County
Department of Public Works

74 North School St. Phone: (760)932-5440
 Post Office Box 457 Fax: (760)932-5441
 Bridgeport, CA 93517 monopw@mono.ca.gov

MONO COUNTY
 CEMETERIES
 HEADSTONE DETAIL

Attachment
 2

DATE: 3/8/07