

MONO COUNTY RIGHT EDGE LINE STRIPING PROJECT PROJECT NO. 9320

GENERAL CONSTRUCTION AND SITEWORK SPECIFICATIONS

GENERAL:

1. ALL WORK SHALL CONFORM TO THESE PLANS, PROJECT SPECIFICATIONS, MONO COUNTY ORDINANCES AND STANDARDS, AND "A POLICY ON GEOMETRIC DESIGN OF HIGHWAYS AND STREETS" (2018 GREEN BOOK) ISSUED BY THE AMERICAN ASSOCIATION OF STATE HIGHWAY AND TRANSPORTATION OFFICIALS (AASHTO). RELEVANT PLAN DETAILS AND SPECIFICATIONS ARE ADOPTED FROM CALIFORNIA DEPARTMENT OF TRANSPORTATION (CALTRANS) STANDARD SPECIFICATIONS AND STANDARD PLANS (2023 EDITION). IN THE EVENT OF A CONFLICT BETWEEN THE PRECEDING DOCUMENTS, THE CONTRACTOR SHALL INFORM THE RESIDENT ENGINEER IMMEDIATELY. THE MONO COUNTY ENGINEERING DEPARTMENT WILL DECIDE WHICH DOCUMENT APPLIES TO THE CONFLICT.
3. CONTRACTOR SHALL CALL USA ALERT AT (800) 642-2444 AT LEAST 48 HOURS PRIOR TO STARTING WORK. UTILITIES SHOWN ON THESE PLANS ARE LOCATED BASED ON AVAILABLE RECORDS AND FIELD MEASUREMENTS. IT IS THE CONTRACTOR'S RESPONSIBILITY TO VERIFY THE EXACT LOCATION AND DEPTH OF ALL UTILITIES PRIOR TO CONSTRUCTION.
4. ANY EVIDENCE OF THE HISTORICAL PRESENCE OF MAN FOUND DURING CONSTRUCTION SHALL BE BROUGHT TO THE ATTENTION OF THE MONO COUNTY PUBLIC WORKS DEPARTMENT AND ALL CONSTRUCTION ACTIVITIES SHALL CEASE UNTIL AUTHORIZED BY THAT DEPARTMENT.
5. A PRE-CONSTRUCTION MEETING IS REQUIRED PRIOR TO COMMENCING ANY SITE ACTIVITIES. MONO COUNTY PUBLIC WORKS DEPARTMENT WILL COORDINATE THIS MEETING WITH THE CONTRACTOR AND OTHER RELEVANT PARTIES.
6. CONSTRUCTION ACTIVITIES SHALL BE LIMITED TO THE HOURS OF 7:00 AM TO 7:00 PM MONDAY THROUGH SATURDAY (NO OPERATIONS ALLOWED ON SUNDAY). CONTRACTOR SHALL KEEP NOISE LEVELS OF CONSTRUCTION EQUIPMENT TO A MINIMUM, USING SOUND MUFFLING DEVICES IN ACCORDANCE WITH PREVAILING REQUIREMENTS. SITE PREPARATION AND CONSTRUCTION SHALL BE CONDUCTED SO AS TO MINIMIZE EXCESSIVE NOISE, DUST, DEBRIS AND DISTURBANCE TO BUSINESSES OR RESIDENTS.
7. THE LIMITS OF CONSTRUCTION SPECIFIED ON THESE PLANS SHALL BE CAREFULLY AND FULLY FLAGGED PRIOR TO START OF CONSTRUCTION IN A MANNER TO PREVENT DAMAGE TO VEGETATION AND DISTURBANCE TO SOILS OUTSIDE THE CONSTRUCTION AREA. SITE-DISTURBING ACTIVITIES SHALL BE RESTRICTED TO THE IDENTIFIED BOUNDARIES OF THE PROJECT.
8. RESTRICTIONS ON THE MOVEMENTS OF HEAVY EQUIPMENT SHALL BE ACCOMPLISHED THROUGH THE ESTABLISHMENT OF DESIGNATED TRAVEL ROUTES AND BARRIERS WHICH PREVENT CUTTING, SCARRING AND ROOT DAMAGE TO TREES AND SHRUBS NOT BEING REMOVED.
9. CONTRACTOR SHALL BE RESPONSIBLE FOR, AND WILL BEAR THE COST OF, RESETTING ANY SURVEY STAKES OR MONUMENTS DESTROYED BY HIS OPERATIONS.

MATERIALS:

10. PAINT STRIPING SHALL CONFORM TO THE 2023 CALTRANS STANDARD SPECIFICATIONS, SECTION 84, MARKINGS, OR AS APPROVED BY THE COUNTY ENGINEER.

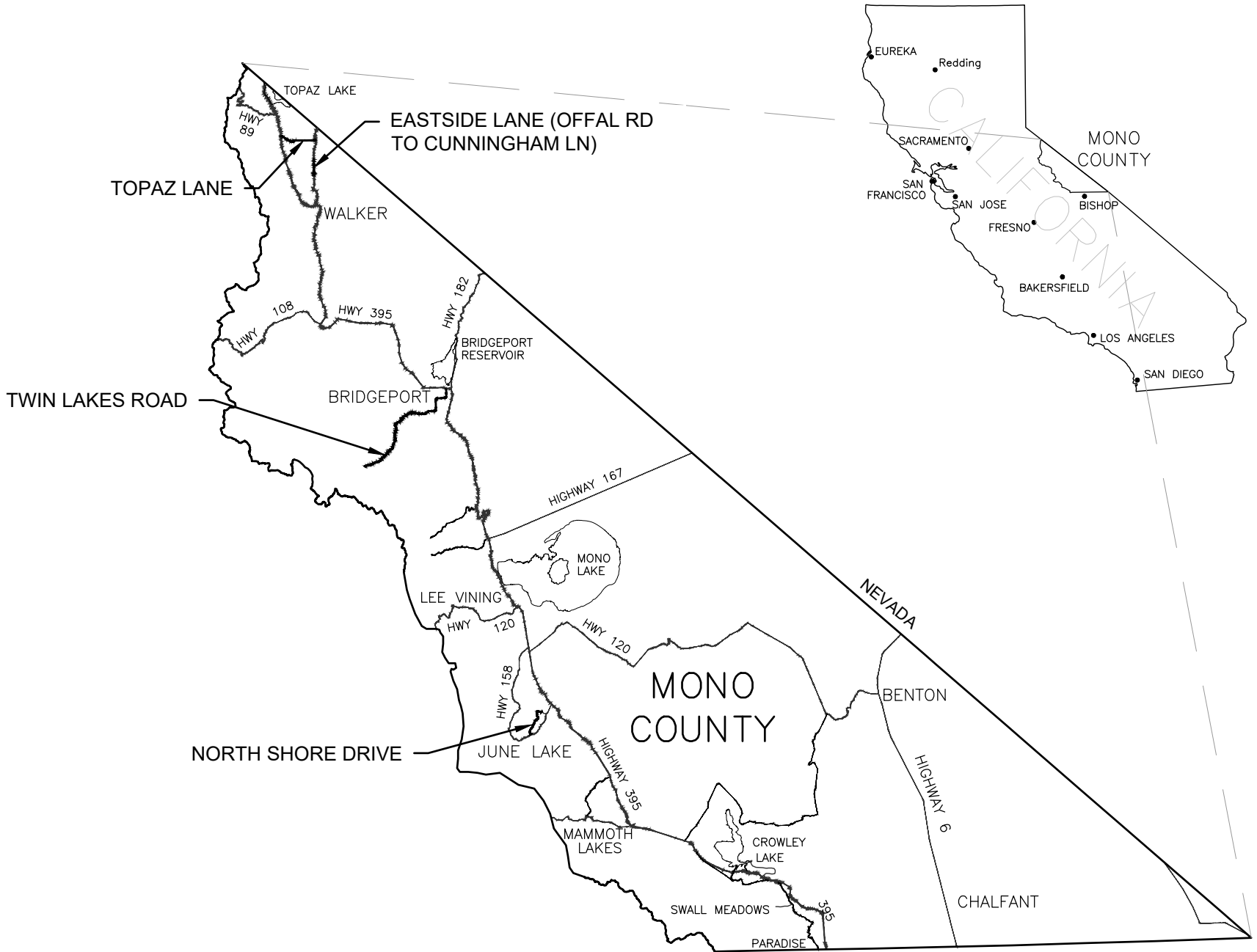

PROJECT LOCATION MAP

INDEX TO SHEETS

- C1: TITLE SHEET
- C2: NORTH SHORE DRIVE
- C3: TWIN LAKES ROAD
- C4: TOPAZ LANE
- C5: EASTSIDE LANE

REFERENCED CALTRANS STANDARD PLANS (2023):

1. A20B: PAVEMENT MARKERS AND TRAFFIC LINES – TYPICAL DETAILS



PREPARED & SUBMITTED BY:
 REGISTERED PROFESSIONAL ENGINEER
 THOMAS A. PLATZ
 No. C 41039
 CIVIL ENGINEER
 STATE OF CALIFORNIA
 DATE: 01/16/2024

Copyright (C) 2023 by Triad/Holmes Associates. This Document is Intended Only for Use on the Project Specified in the Title Block. Any Reproduction of this Document, Without the Express Written Consent of Triad/Holmes, is Prohibited.

REVISIONS:	BY:

PREPARED FOR:
 MONO COUNTY DEPARTMENT OF PUBLIC WORKS
 POST OFFICE BOX 457
 14 NORTH SCHOOL STREET
 BRIDGEPORT, CALIFORNIA 93517

MONO COUNTY RIGHT EDGE LINE STRIPING PROJECT
 TITLE SHEET
 MONO COUNTY, STATE OF CALIFORNIA

DATE	01/16/2024
SCALE	AS NOTED
DRAWN	MYP
JOB NO.	01.4457
DWG	C1
SHEET	1 OF 5

APPROVED BY: MONO COUNTY DEPARTMENT OF PUBLIC WORKS

 PAUL E. ROTEN DATE 01/17/2024
 P.E. C56891

Z:\01_Mammoth\44931 Mono County HSP Edge\ACAD\HSP Striping_R1.dwg Jan 18, 2024 - 1:10pm, mpanolovsky

CONSTRUCTION NOTES

① PAINT 6" RIGHT EDGELINE PER CALTRANS STANDARD SPECIFICATIONS, SECTION 84, MARKINGS, AND CALTRANS STANDARD PLAN A20B, DETAIL 27B. MATCH EXISTING PAINT STRIPING LOCATION.

TOTAL RIGHT EDGELINE STRIPING LENGTH = 142,138 LF

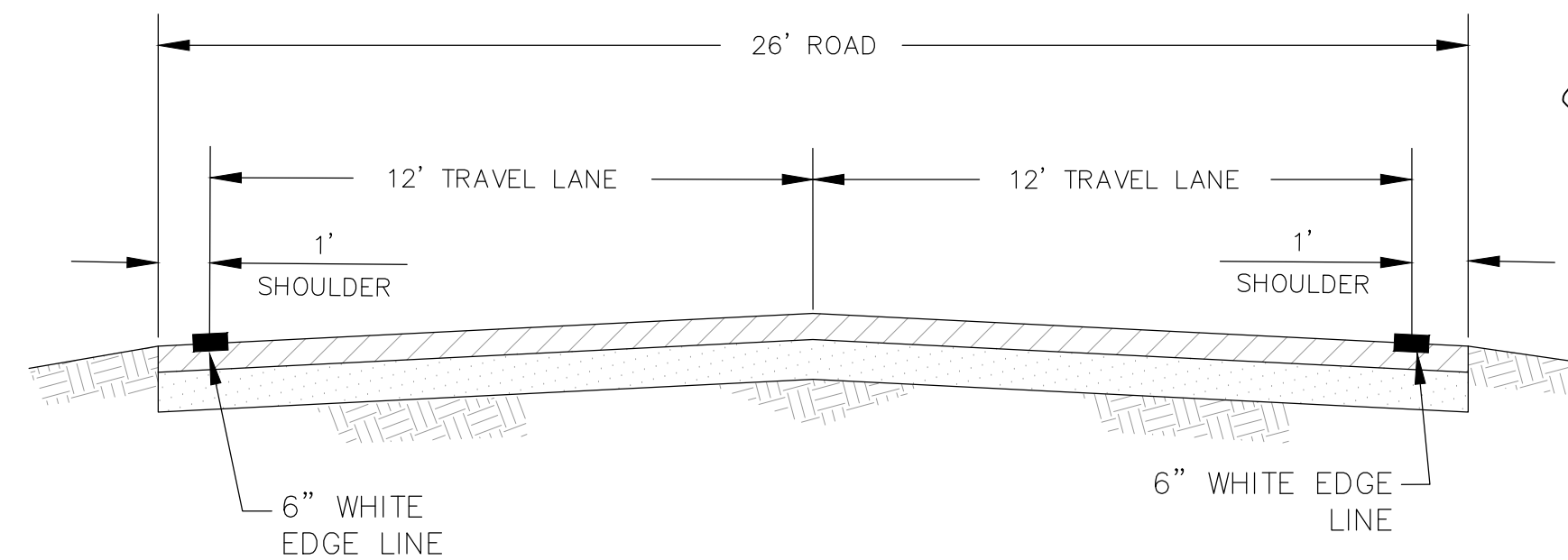
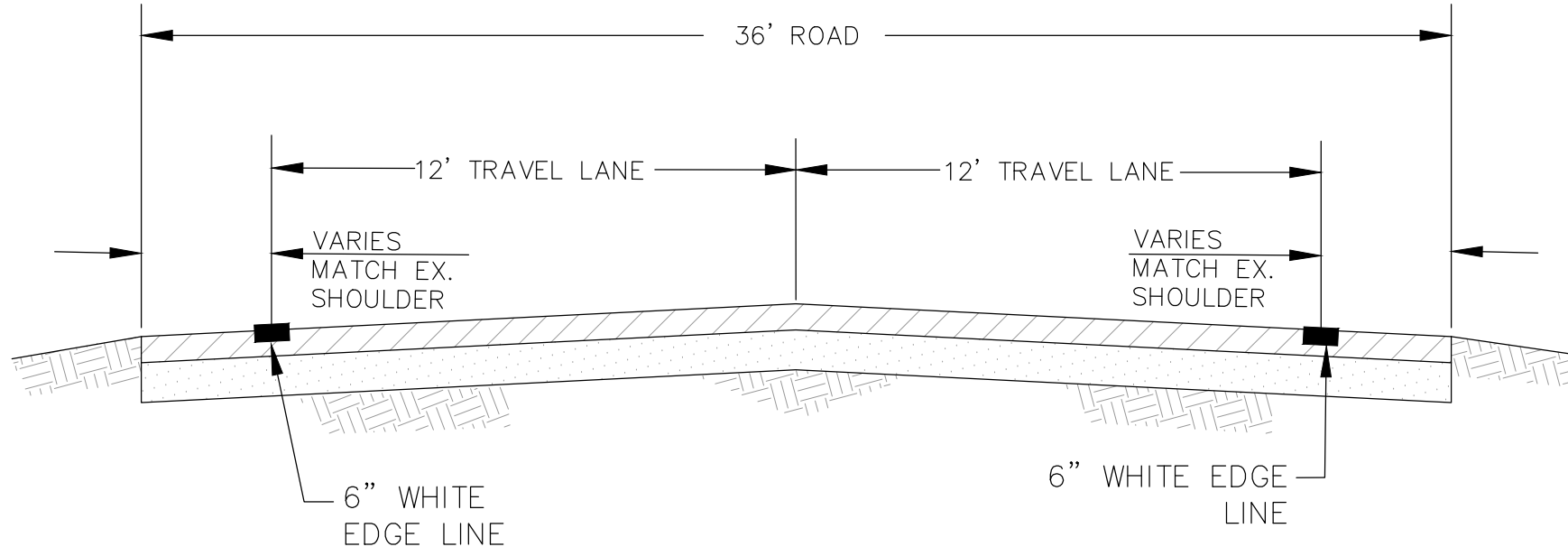

TWIN LAKES ROAD STRIPING DETAIL
HWY 395 TO END
N.T.S.

ROAD SECTION 1

ROAD SECTION 2

BEGIN STRIPING

END STRIPING

BRIDGEPORT
KINGSLEY STREET

Lakes
Twin
Hunewill Ranch Rd

Spur Ct.
Hackamore Pl.
Kayak Rd.

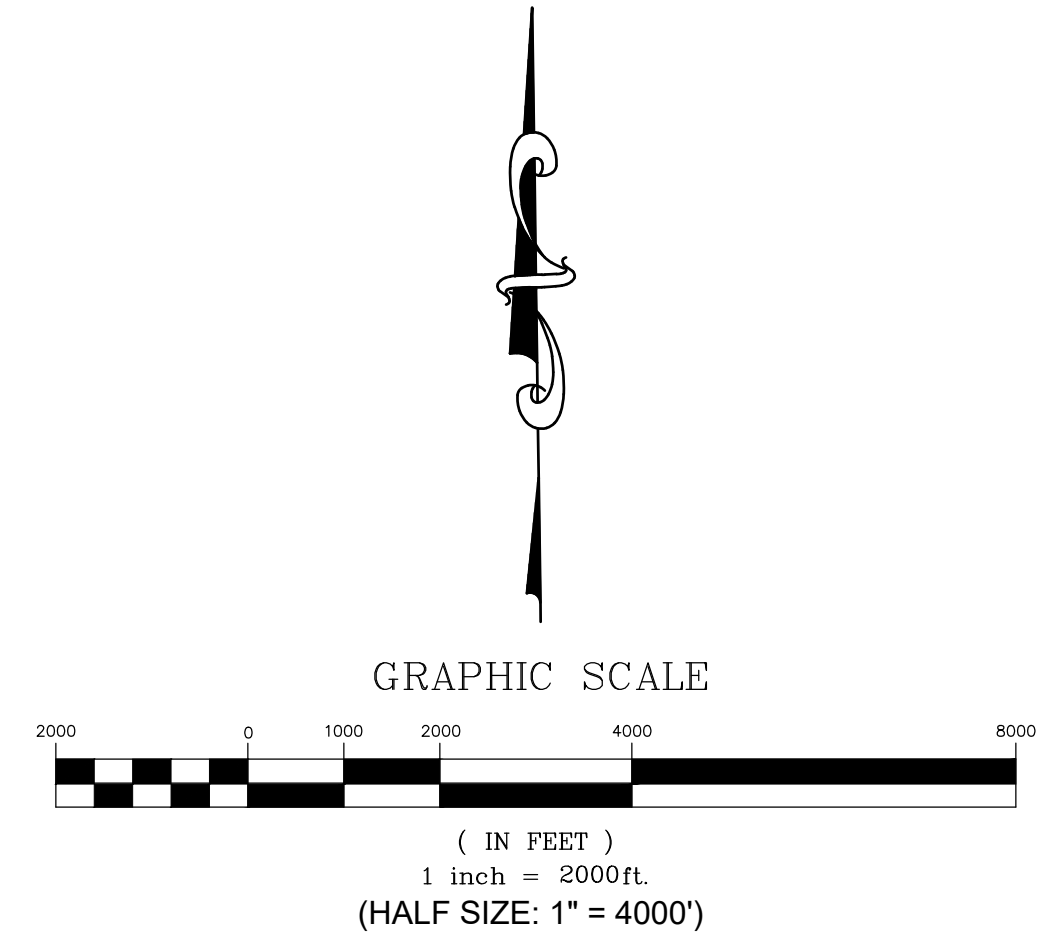

PREPARED & SUBMITTED BY:

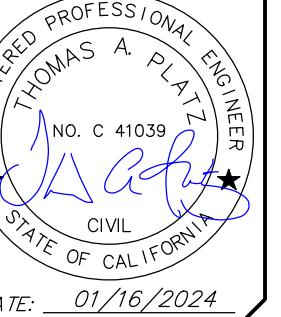

Copyright (C) 2023 by Triad/Holmes Associates. All Rights Reserved. This Document is Intended Only for Use on the Project Specified in the Title Block. Any Reproduction of this Document, Without the Express Written Consent of Triad/Holmes, is Prohibited.

REVISIONS:	BY:

PREPARED FOR:

MONO COUNTY DEPARTMENT OF PUBLIC WORKS
POST OFFICE BOX 457
14 NORTH SCHOOL STREET
BRIDGEPORT, CALIFORNIA 93517

MONO COUNTY RIGHT EDGE LINE STRIPING PROJECT
TWIN LAKES ROAD
MONO COUNTY, STATE OF CALIFORNIA

DATE	01/16/2024
SCALE	AS NOTED
DRAWN	MYP
JOB NO.	01.4457
DWG	C3
SHEET	3 OF 5

Z:\01_Mammoth\44931 Mono County VSP Edge L\CAD\VSP Striping RL.dwg Jan 18, 2024 - 1:10pm, mpanolovsky

Z:\01_Mammoth\4493.1 Mono County VSP Edge\ACAD\VSP Striping PL.dwg - 1:10pm, mpanolovsky

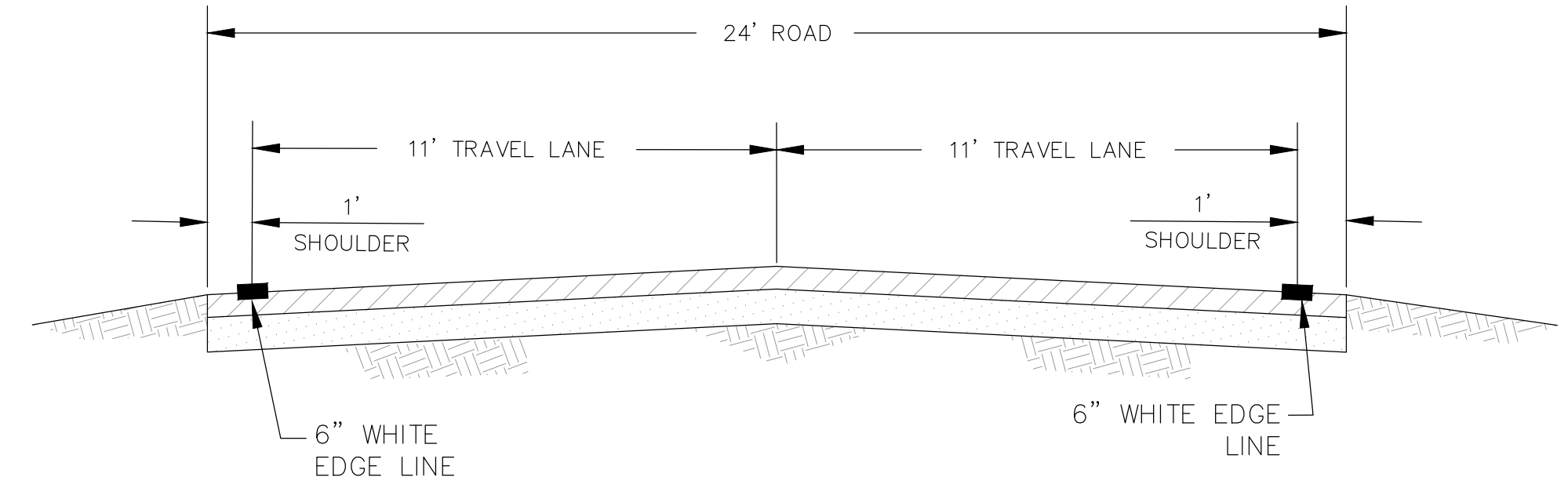
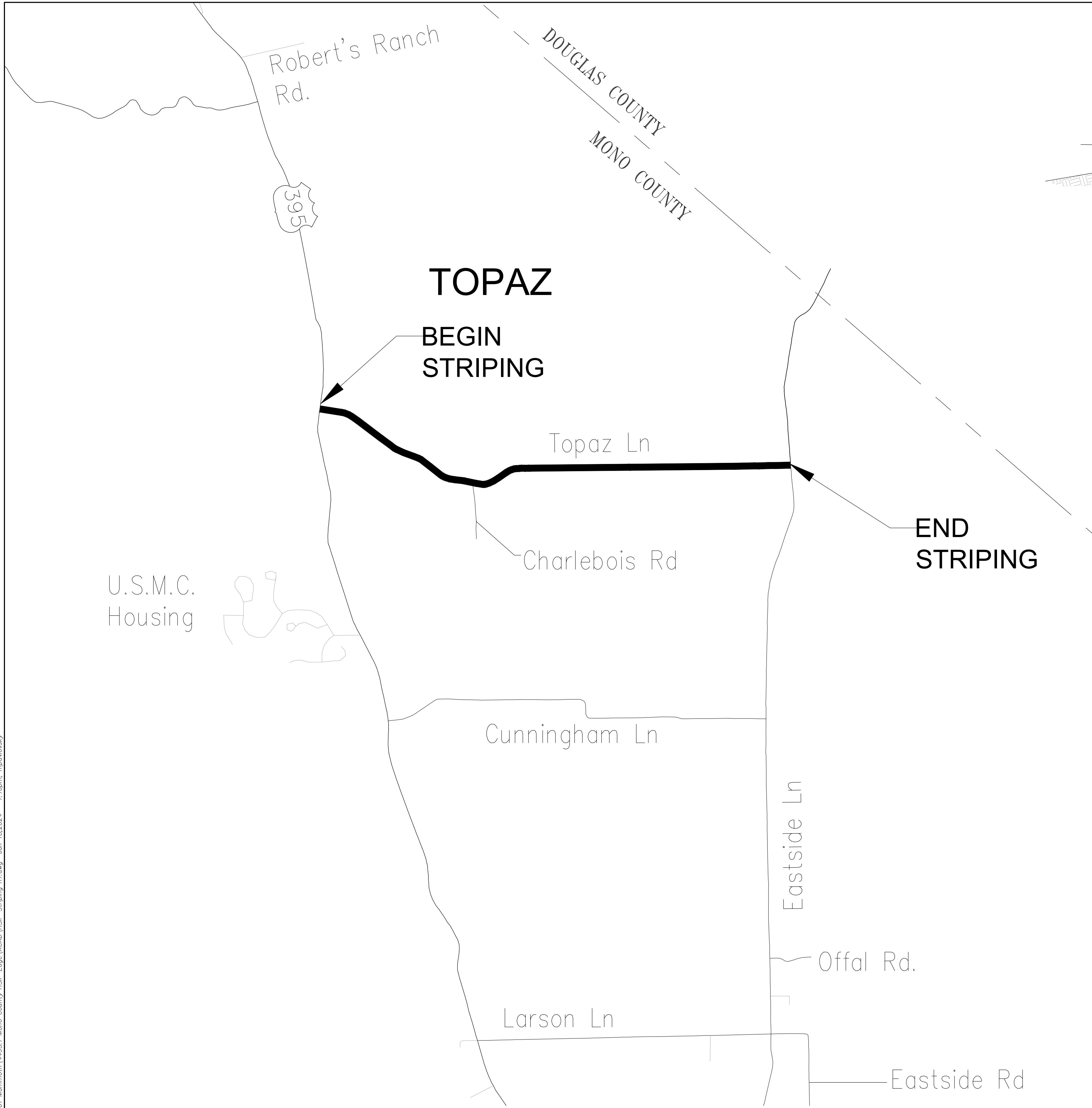



TOPAZ LANE STRIPING DETAIL
HIGHWAY 395 TO EASTSIDE LANE
N.T.S.

CONSTRUCTION NOTES

- ① PAINT 6" RIGHT EDGELINE PER CALTRANS STANDARD SPECIFICATIONS, SECTION 84, MARKINGS; AND CALTRANS STANDARD PLAN A20B, DETAIL 27B.

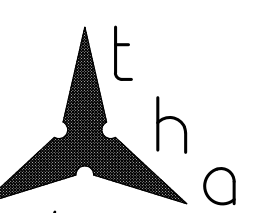
TOTAL RIGHT EDGELINE STRIPING LENGTH = 37,066 LF
TOPAZ LANE HAS NO EXISTING RIGHT EDGELINE PAINT.



 triad/holmes assoc.
 civil engineering
 land surveying
 MAMMOTH LAKES
 BISHOP
 REDWOOD CITY
 PREPARED & SUBMITTED BY:

 THOMAS A. PLATZ
 No. C 41039
 CIVIL ENGINEER
 STATE OF CALIFORNIA
 DATE: 01/16/2024

Copyright (C) 2023 by
 Triad/Holmes Associates
 All Rights Reserved. This
 Document is intended
 Only for Use on the
 Project Specified in the
 Title Block. Any
 Reproduction of this
 Document, Without
 the Express Written
 Consent of Triad/Holmes,
 is Prohibited.

REVISIONS:	BY:

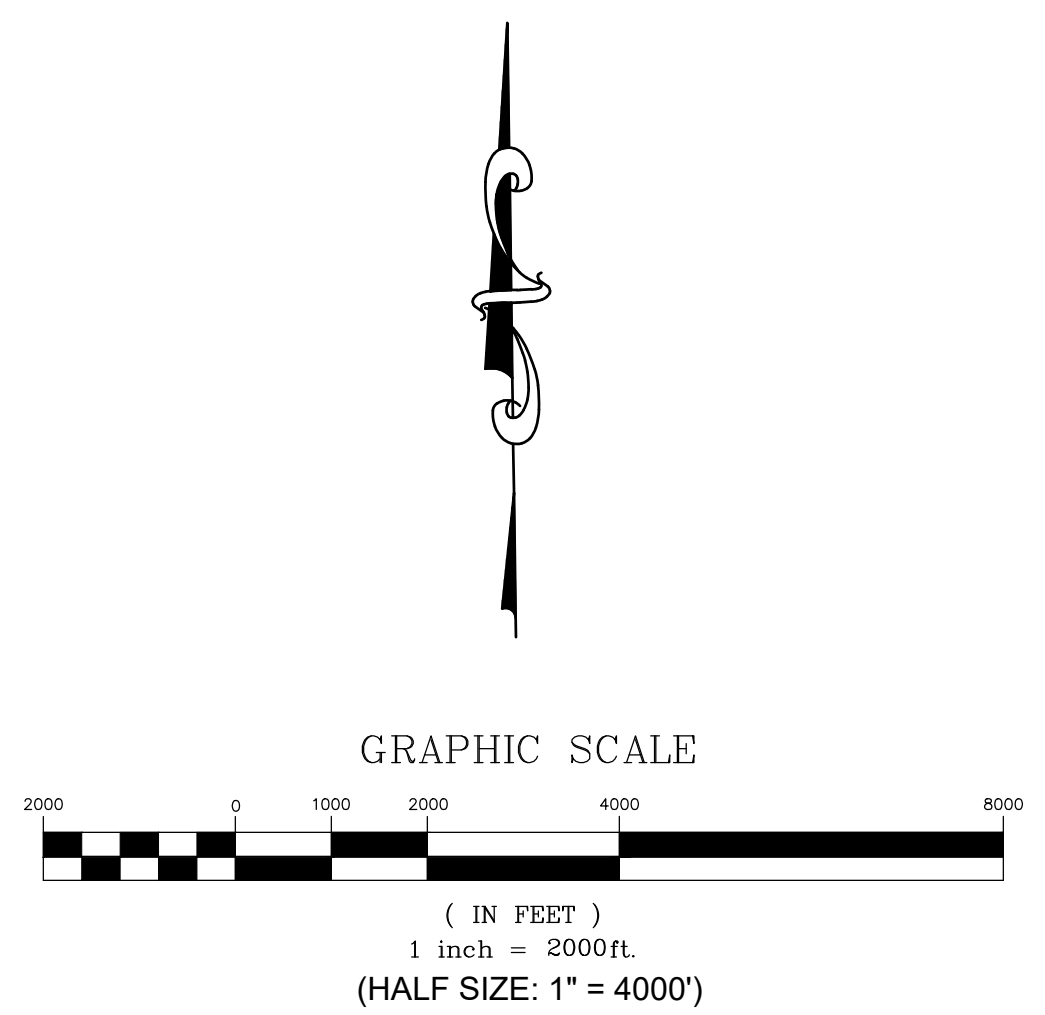
PREPARED FOR:
 MONO COUNTY DEPARTMENT OF
 PUBLIC WORKS
 POST OFFICE BOX 457
 14 NORTH SCHOOL STREET
 BRIDGEPORT, CALIFORNIA 93517

MONO COUNTY RIGHT EDGE LINE
 STRIPING PROJECT
 TOPAZ LANE
 MONO COUNTY, STATE OF CALIFORNIA



DATE	01/16/2024
SCALE	AS NOTED
DRAWN	MYP
JOB NO.	01.4457
DWG	C4
SHEET	4 OF 5

Z:\01_Mammoth\4493.1 Mono County VSP Edge\ACAD\ISP\Striping\RT.dwg - Jan 18, 2024 - 1:10pm, mpanolovsky

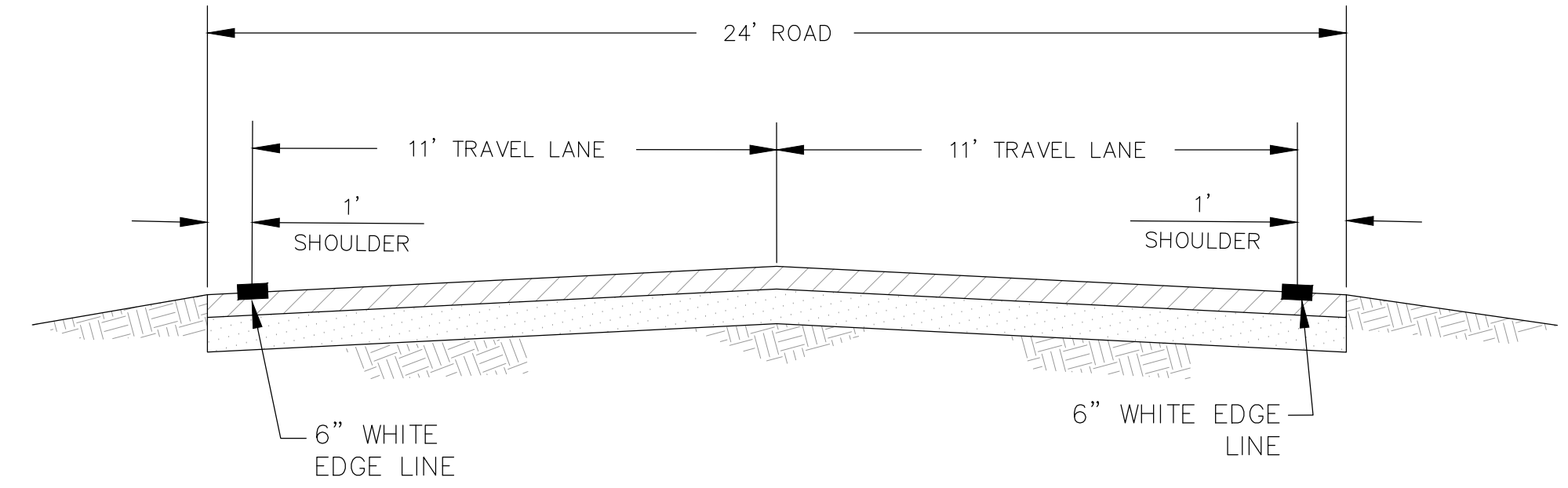
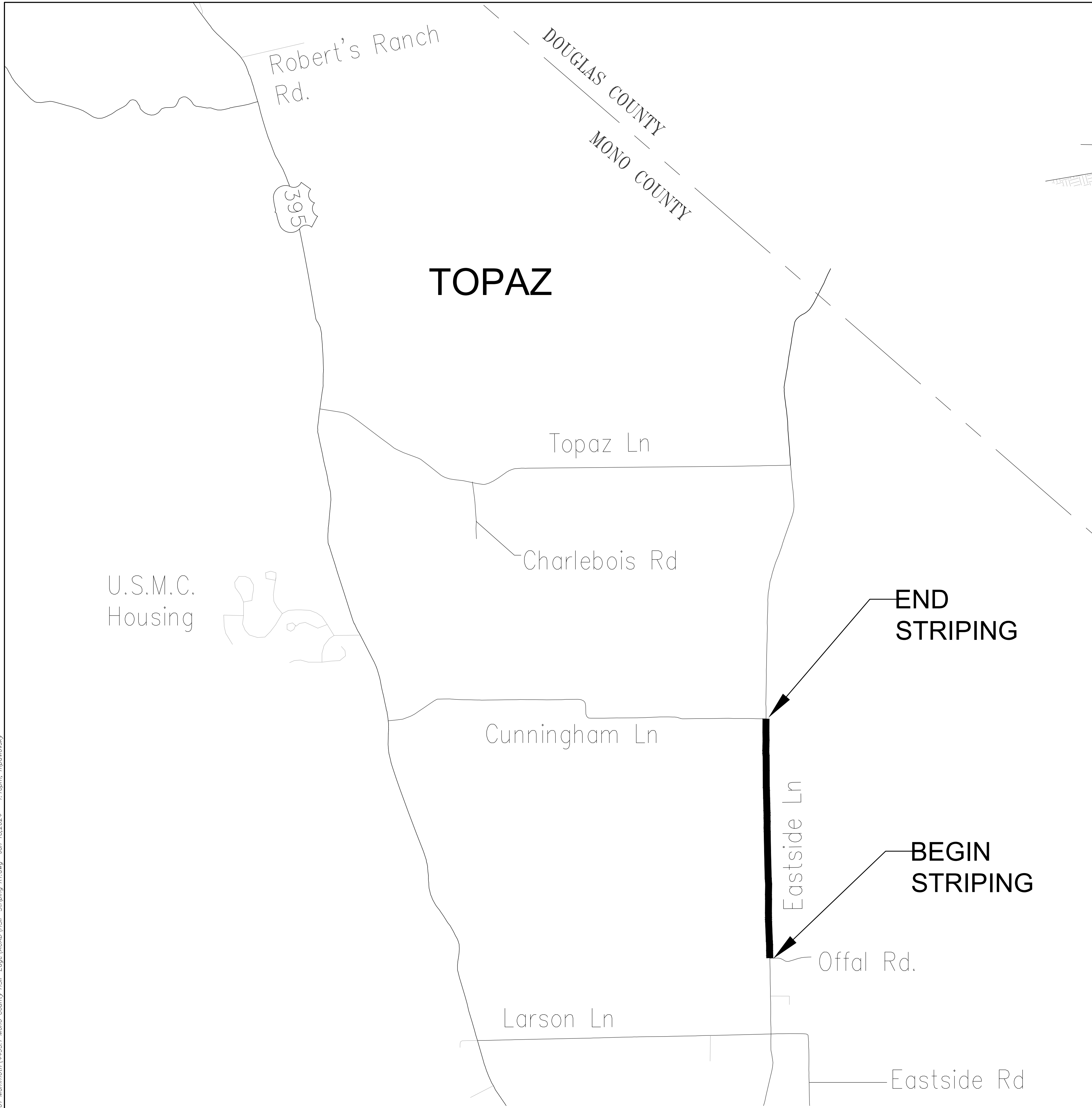

EASTSIDE LANE STRIPING DETAIL
OFFAL ROAD TO CUNNINGHAM LANE
N.T.S.

CONSTRUCTION NOTES

- ① PAINT 6" RIGHT EDGELINE PER CALTRANS STANDARD SPECIFICATIONS, SECTION 84, MARKINGS; AND CALTRANS STANDARD PLAN A20B, DETAIL 27B. MATCH EXISTING PAINT STRIPING LOCATION.

TOTAL RIGHT EDGELINE STRIPING LENGTH = 18,586 LF
EXISTING PAINT STRIPING WIDTH IS 4".

t h a
triad/holmes assoc.
civil engineering
land surveying
MAMMOTH LAKES
BISHOP
REDWOOD CITY

PREPARED & SUBMITTED BY:
REGISTERED PROFESSIONAL ENGINEER
THOMAS A. PLATZ
No. C 41039
CIVIL
STATE OF CALIFORNIA
DATE: 01/16/2024

Copyright (C) 2023 by Triad/Holmes Associates
All Rights Reserved. This Document is Intended Only for Use on the Project Specified in the Title Block. Any Reproduction of this Document, Without the Express Written Consent of Triad/Holmes, is Prohibited.

REVISIONS:	BY:

PREPARED FOR:
MONO COUNTY DEPARTMENT OF PUBLIC WORKS
POST OFFICE BOX 457
14 NORTH SCHOOL STREET
BRIDGEPORT, CALIFORNIA 93517

MONO COUNTY RIGHT EDGE LINE STRIPING PROJECT
EASTSIDE LANE (OFFAL RD TO CUNNINGHAM LN)
MONO COUNTY, STATE OF CALIFORNIA

DATE: 01/16/2024
SCALE: AS NOTED
DRAWN: MYP
JOB NO.: 01.4457
DWG: C5
SHEET 5 OF 5

GRAPHIC SCALE
(IN FEET)
1 inch = 2000ft.
(HALF SIZE: 1" = 4000')