

CONSTRUCTION NOTES

① PAINT 6" RIGHT EDGELINE PER CALTRANS STANDARD SPECIFICATIONS, SECTION 84, MARKINGS; AND CALTRANS STANDARD PLAN A20B, DETAIL 27B. MATCH EXISTING PAINT STRIPING LOCATION.

TOTAL RIGHT EDGELINE STRIPING LENGTH = 37,488 LF

PREPARED & SUBMITTED BY:



Copyright (C) 2023 by Triad/Holmes Associates
All Rights Reserved. This Document is Intended Only for Use on the Project Specified in the Title Block. Any Reproduction of this Document or Portions of this Document, Without the Express Written Consent of Triad/Holmes, is Prohibited.

REVISIONS: BY:

NO.	DATE	DESCRIPTION	BY

PREPARED FOR:

MONO COUNTY DEPARTMENT OF PUBLIC WORKS
POST OFFICE BOX 457
14 NORTH SCHOOL STREET
BRIDGEPORT, CALIFORNIA 93517

MONO COUNTY RIGHT EDGE LINE STRIPING PROJECT
NORTH SHORE DRIVE
MONO COUNTY, STATE OF CALIFORNIA

DATE 01/16/2024

SCALE AS NOTED

DRAWN MYP

JOB NO. 01.4457

DWG

C2

SHEET 2 OF 5

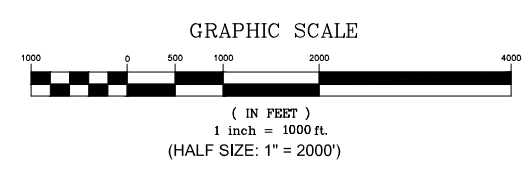
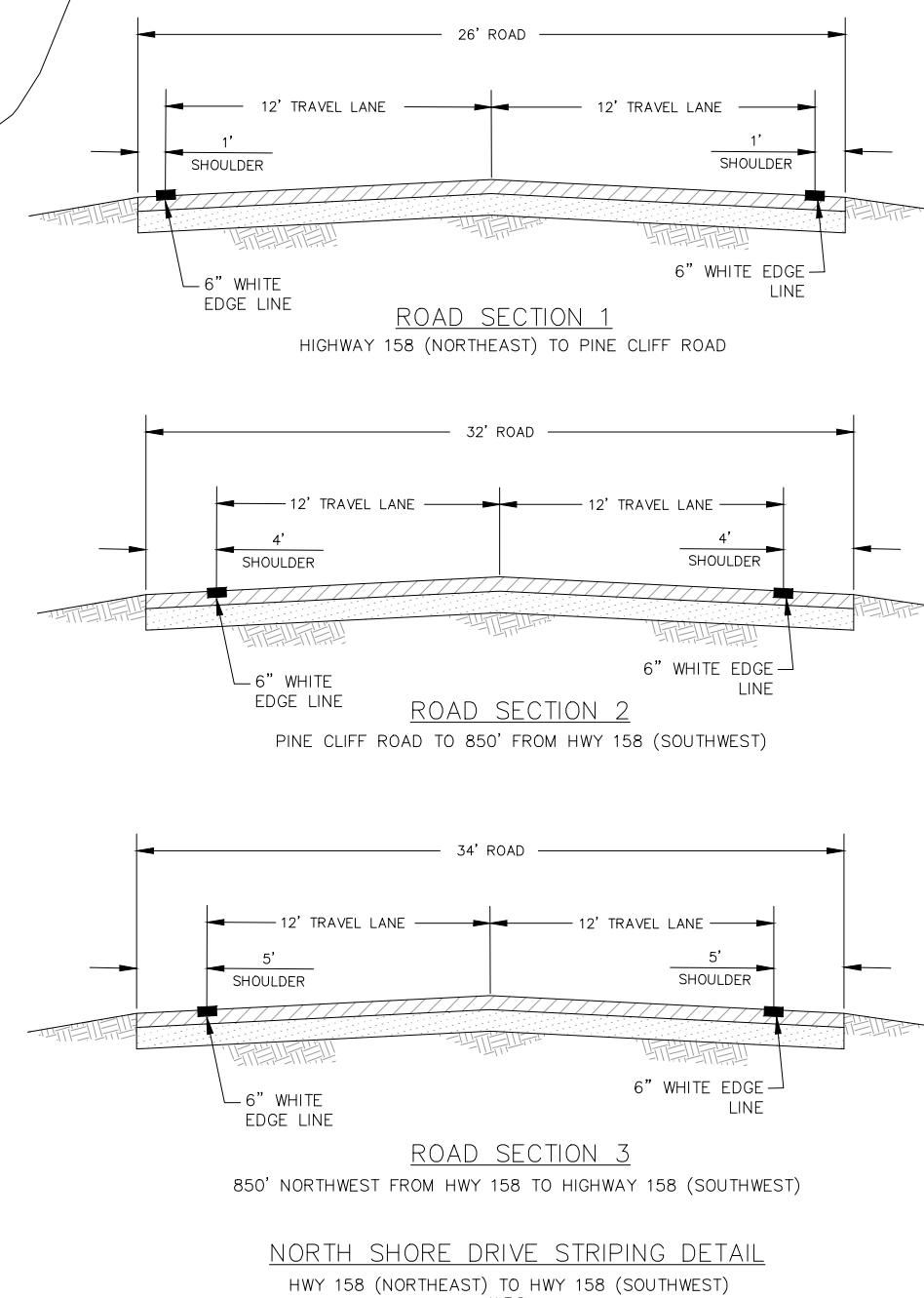
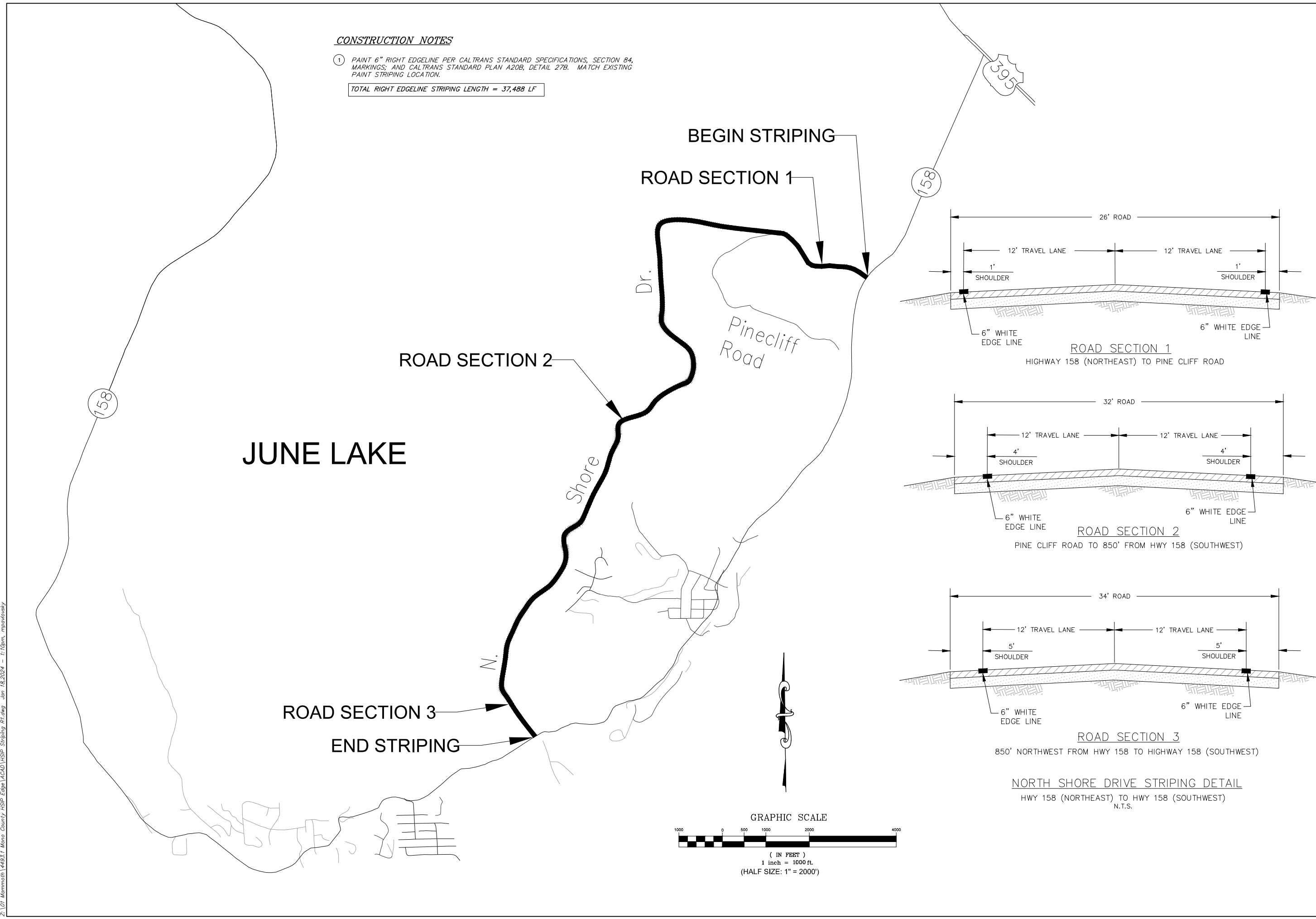

Z:\01 Mammoth\44571 Mono County HSP Edge\ACAD\HSP Striping Pl.dwg Jan 18, 2024 - 1:10pm, mpanolovsky

CONSTRUCTION NOTES

① PAINT 6" RIGHT EDGELINE PER CALTRANS STANDARD SPECIFICATIONS, SECTION 84, MARKINGS, AND CALTRANS STANDARD PLAN A20B, DETAIL 27B. MATCH EXISTING PAINT STRIPING LOCATION.

TOTAL RIGHT EDGELINE STRIPING LENGTH = 142,138 LF

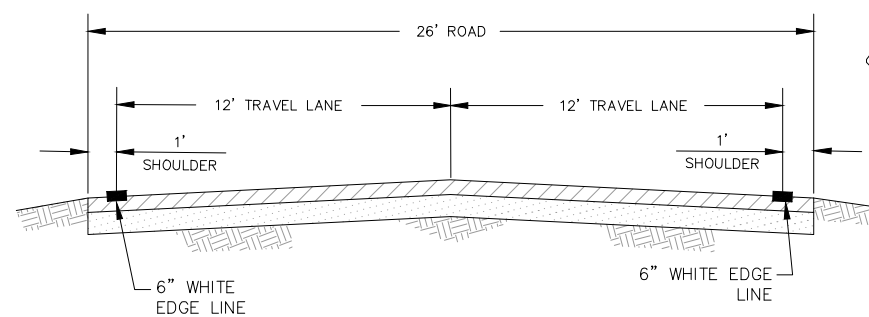
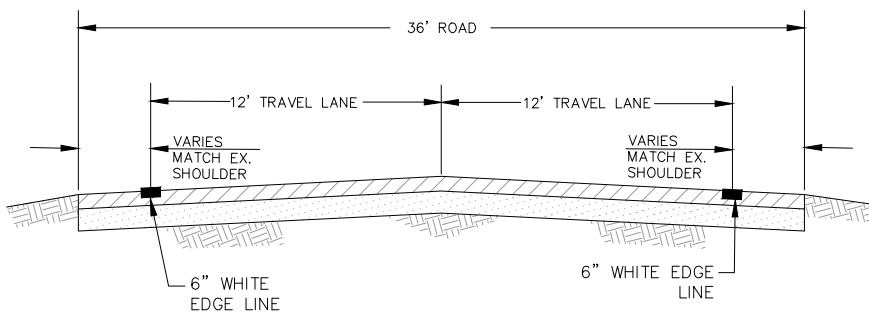

TWIN LAKES ROAD STRIPING DETAIL
HWY 395 TO END
N.T.S.

BEGIN STRIPING

ROAD SECTION 1

ROAD SECTION 2

END STRIPING

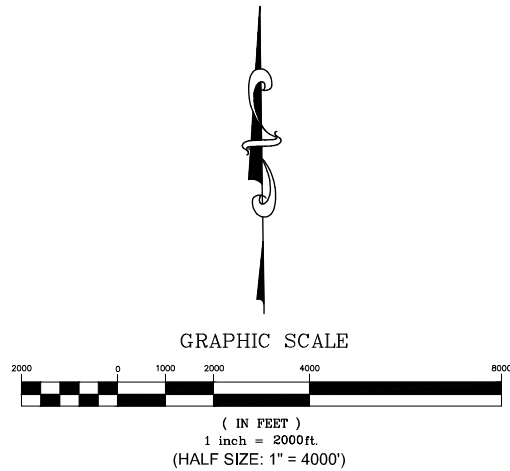
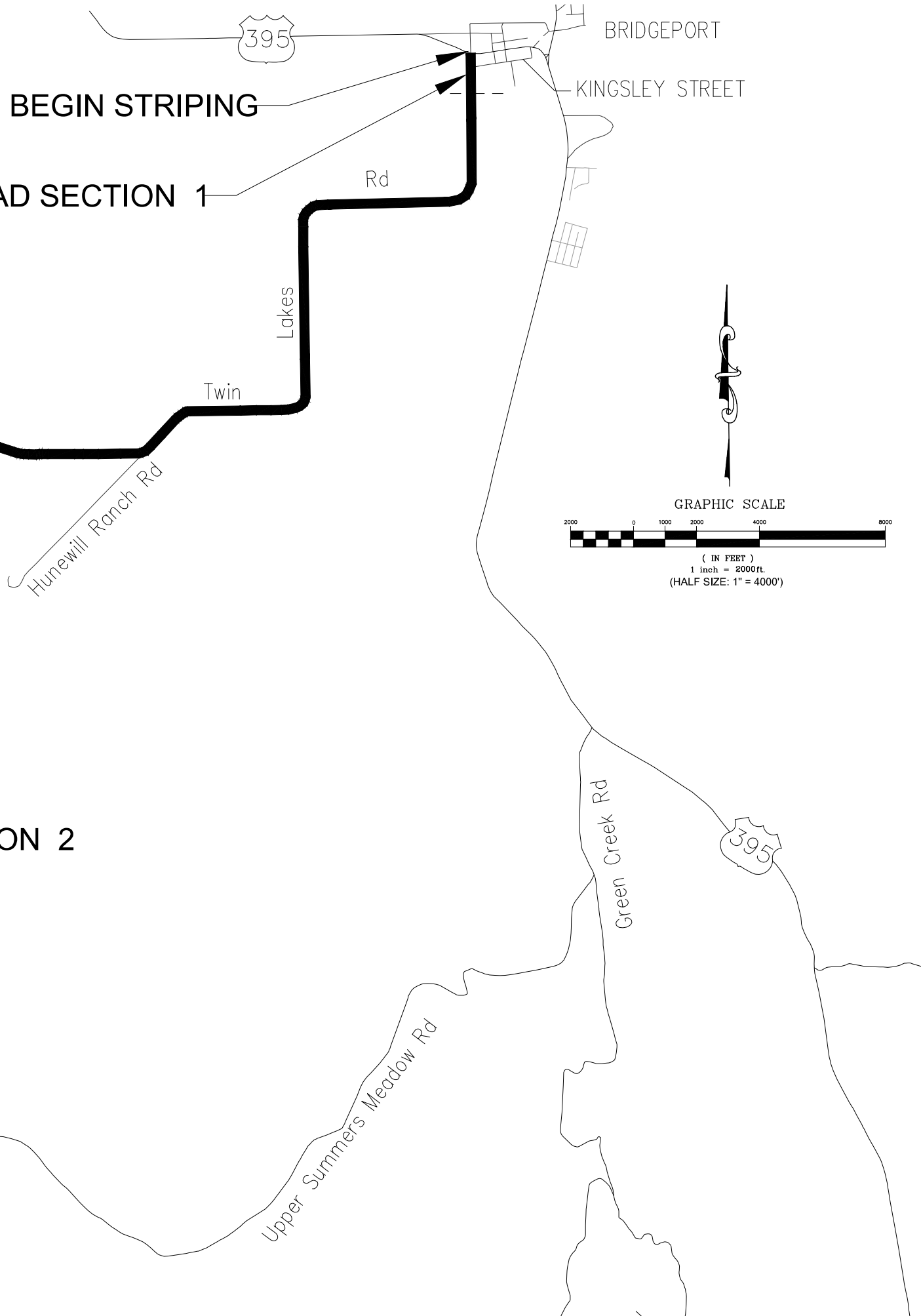

Z:\01_Mammoth\44931 Mono County HSP Edge\ACAD\HSP Stripping Pl.dwg Jan 18, 2024 - 1:10pm, mpanolovsky

t h a
triad/holmes assoc.
civil engineering
land surveying

MAMMOTH LAKES
BISHOP
REDWOOD CITY

PREPARED & SUBMITTED BY:
REGISTERED PROFESSIONAL ENGINEER
THOMAS A. PLATZ
No. C 41039
DATE: 01/16/2024

Copyright (C) 2023 by Triad/Holmes Associates
All Rights Reserved. This Document is Intended Only for Use on the Project Specified in the Title Block. Any Reproduction of this Document or Portions of this Document, Without the Express Written Consent of Triad/Holmes, is Prohibited.

REVISIONS:	BY:

PREPARED FOR:
MONO COUNTY DEPARTMENT OF PUBLIC WORKS
POST OFFICE BOX 457
74 NORTH SCHOOL STREET
BRIDGEPORT, CALIFORNIA 93517

MONO COUNTY RIGHT EDGE LINE STRIPING PROJECT
TWIN LAKES ROAD
MONO COUNTY, STATE OF CALIFORNIA

DATE	01/16/2024
SCALE	AS NOTED
DRAWN	MYP
JOB NO.	01.4457
DWG	C3
SHEET	3 OF 5

Z:\01_Mammoth\44931 Mono County HSP Edge\ACAD\HSP Stripping Pl.dwg Jan 18, 2024 - 1:10pm, mpanolovsky

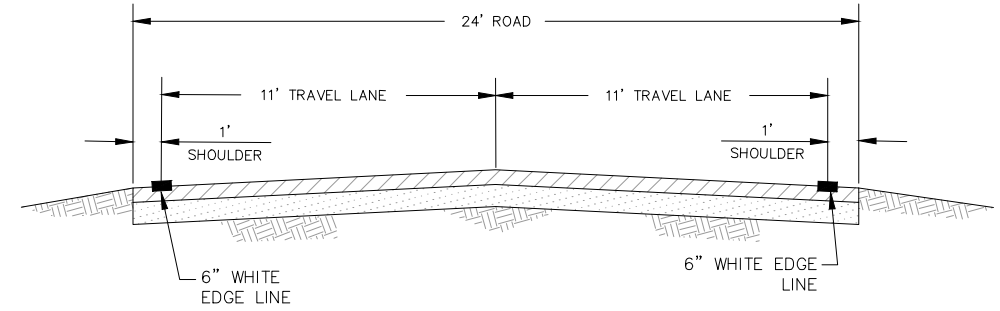
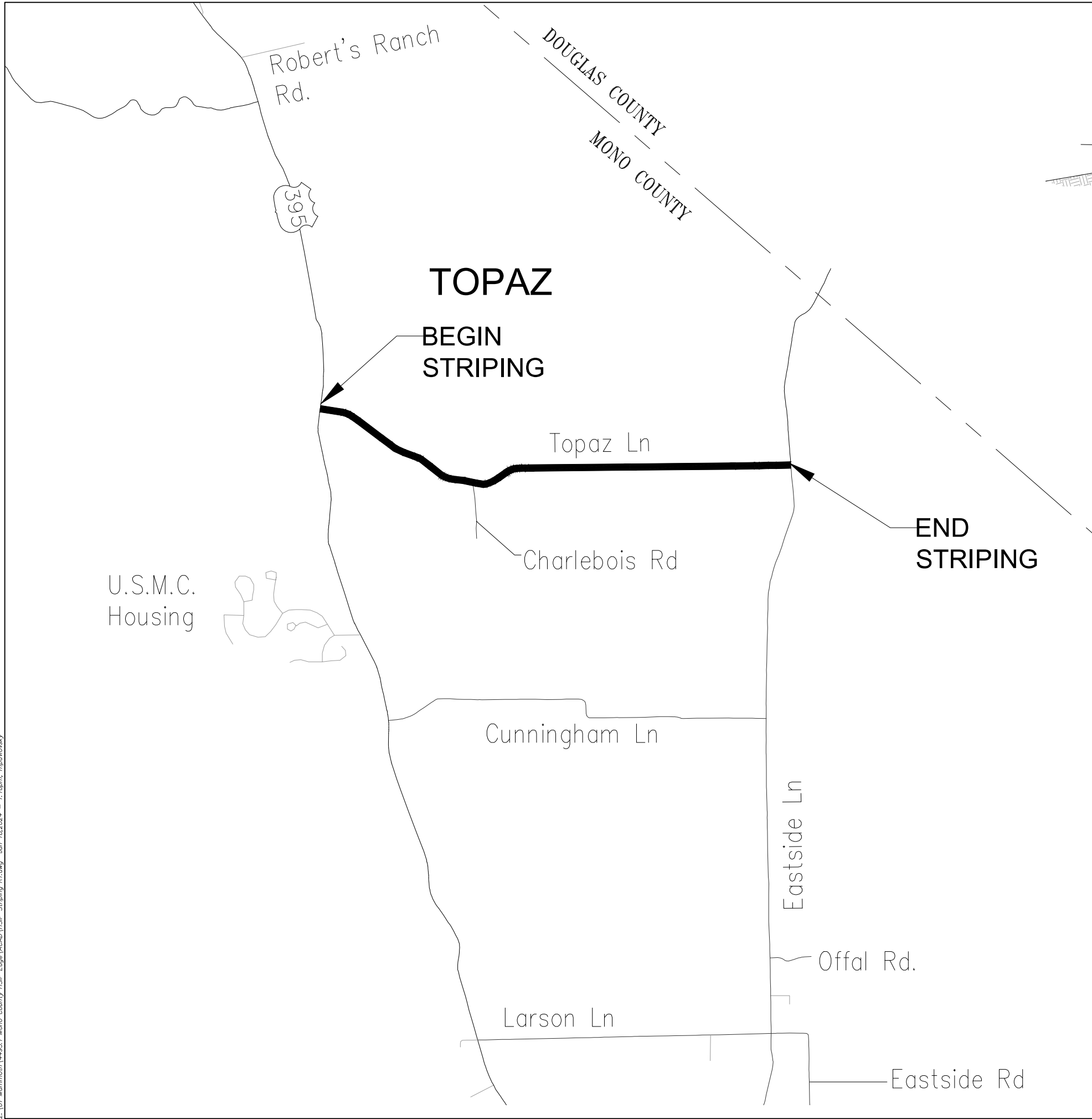

TOPAZ LANE STRIPING DETAIL
HIGHWAY 395 TO EASTSIDE LANE
N.T.S.

CONSTRUCTION NOTES

- ① PAINT 6" RIGHT EDGELINE PER CALTRANS STANDARD SPECIFICATIONS, SECTION 84, MARKINGS; AND CALTRANS STANDARD PLAN A20B, DETAIL 27B.

TOTAL RIGHT EDGELINE STRIPING LENGTH = 37,066 LF
TOPAZ LANE HAS NO EXISTING RIGHT EDGELINE PAINT.

t h a
triad/holmes assoc.
civil engineering
land surveying
MAMMOTH LAKES
BISHOP
REDWOOD CITY

PREPARED & SUBMITTED BY:
REGISTERED PROFESSIONAL ENGINEER
THOMAS A. PLATZ
NO. C 41039
DATE: 01/16/2024

Copyright (C) 2023 by Triad/Holmes Associates
All Rights Reserved. This Document is Intended Only for Use on the Project Specified in the Title Block. Any Reproduction of this Document, Without the Express Written Consent of Triad/Holmes, is Prohibited.

REVISIONS:	BY:

PREPARED FOR:
MONO COUNTY DEPARTMENT OF PUBLIC WORKS
POST OFFICE BOX 457
14 NORTH SCHOOL STREET
BRIDGEPORT, CALIFORNIA 93517

MONO COUNTY RIGHT EDGE LINE STRIPING PROJECT
TOPAZ LANE
MONO COUNTY, STATE OF CALIFORNIA

DATE: 01/16/2024
SCALE: AS NOTED
DRAWN: MYP
JOB NO.: 01.4457
DWG: C4
SHEET 4 OF 5

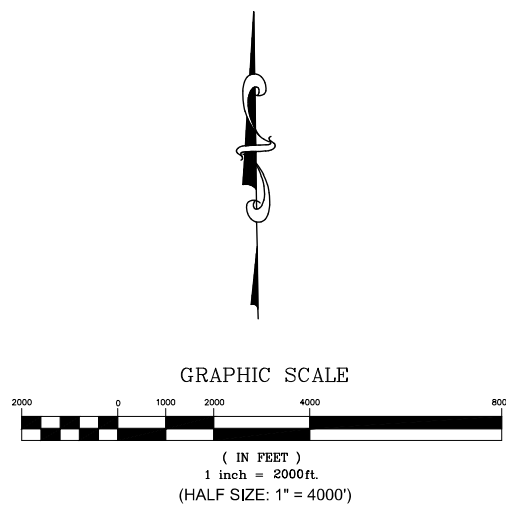

Z:\01_Mammoth\44931 Mono County\ISP Edge\ACAD\ISP Striping Pl.dwg Jan 18, 2024 - 1:10pm, mpanolovsky

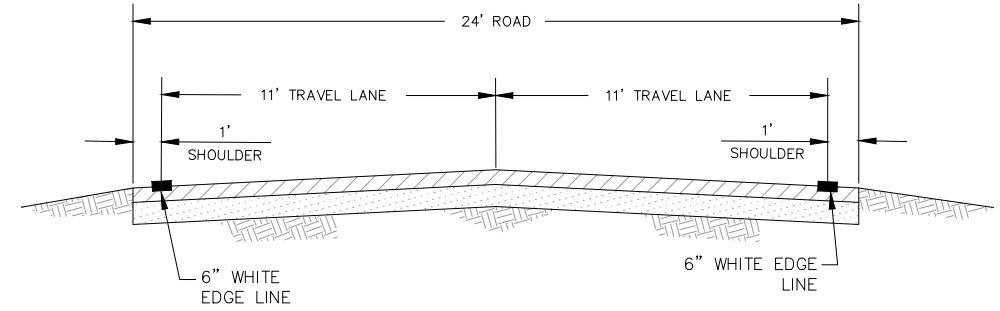
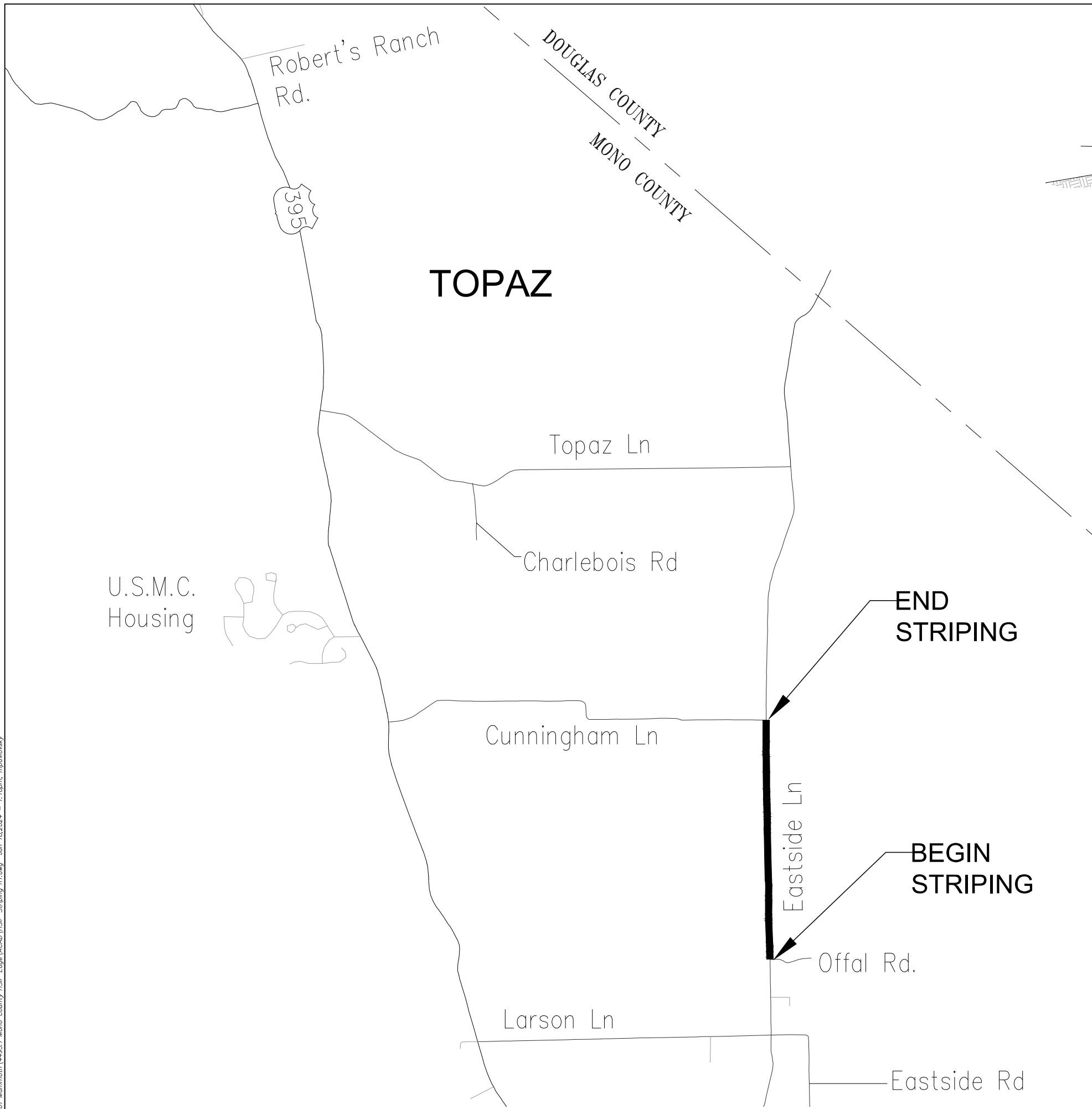

EASTSIDE LANE STRIPING DETAIL
OFFAL ROAD TO CUNNINGHAM LANE
N.T.S.

CONSTRUCTION NOTES

- ① PAINT 6" RIGHT EDGELINE PER CALTRANS STANDARD SPECIFICATIONS, SECTION 84, MARKINGS; AND CALTRANS STANDARD PLAN A20B, DETAIL 27B. MATCH EXISTING PAINT STRIPING LOCATION.

TOTAL RIGHT EDGELINE STRIPING LENGTH = 18,586 LF
EXISTING PAINT STRIPING WIDTH IS 4".

t h a
triad/holmes assoc.
civil engineering
land surveying
MAMMOTH LAKES
BISHOP
REDWOOD CITY

PREPARED & SUBMITTED BY:
REGISTERED PROFESSIONAL ENGINEER
THOMAS A. PLATZ
NO. C 41039
DATE: 01/16/2024

Copyright (C) 2023 by Triad/Holmes Associates
All Rights Reserved. This Document is Intended Only for Use on the Project Specified in the Title Block. Any Reproduction of this Document, Without the Express Written Consent of Triad/Holmes, is Prohibited.

REVISIONS:	BY:

PREPARED FOR:
MONO COUNTY DEPARTMENT OF PUBLIC WORKS
POST OFFICE BOX 457
14 NORTH SCHOOL STREET
BRIDGEPORT, CALIFORNIA 93517

MONO COUNTY RIGHT EDGE LINE STRIPING PROJECT
EASTSIDE LANE (OFFAL RD TO CUNNINGHAM LN)
MONO COUNTY, STATE OF CALIFORNIA

DATE: 01/16/2024
SCALE: AS NOTED
DRAWN: MYP
JOB NO.: 01.4457
DWC: C5
SHEET 5 OF 5

GRAPHIC SCALE
(IN FEET)
1 inch = 2000ft.
(HALF SIZE: 1" = 4000')