

**Mono County
Community Development Department**

PO Box 347
Mammoth Lakes CA, 93546
760.924.1800, fax 924.1801
commdev@mono.ca.gov

Planning Division

PO Box 8
Bridgeport, CA 93517
(760) 932-5420, fax 932-5431
www.monocounty.ca.gov

**PLOT PLAN
CHECKLIST**

Lack of a plot plan or any of the required information will delay the review of your plans by the Planning Division.

PLOT PLANS MUST INCLUDE:

- Name/address/phone number of owner, applicant, plan preparer
- North arrow, scale (1"=20', etc.)
- Assessor's Parcel Number (APN)
- Location/name of boundary streets, surface waters and recorded easements on property (include type and size of any easements)
- Dimensioned property lines/project boundary lines
- Location/outside dimensions/use of proposed structures, driveways, parking areas -- distance between structures and setbacks to all property lines and surface waters
- Contour lines if the property is in a flood zone

PLOT PLANS MUST ALSO INCLUDE THE FOLLOWING, if applicable:

- Location/outside dimensions/use of existing structures: distance between structures and setbacks to all property lines and surface waters
- Location and name of surface waters within 50 feet of property
- Location of utility lines 115 kV or greater within 35 feet of property
- Unusual site features (e.g., hilly terrain, drainages) on property

NOTE: New development in the Swall Meadows area are required to submit a Wheeler Crest Design Review application.

The items checked above have been included on the submitted plot plan.

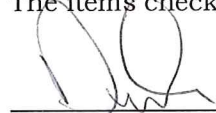

Signature of Applicant

2.28.22

Date

Mono County Community Development Department

Planning Division

PO Box 347
Mammoth Lakes CA, 93546
760.924.1800, fax 924.1801
commdev@mono.ca.gov

PO Box 8
Bridgeport, CA 93517
(760) 932-5420, fax 932-5431
www.monocounty.ca.gov

PLOT PLAN EXAMPLE

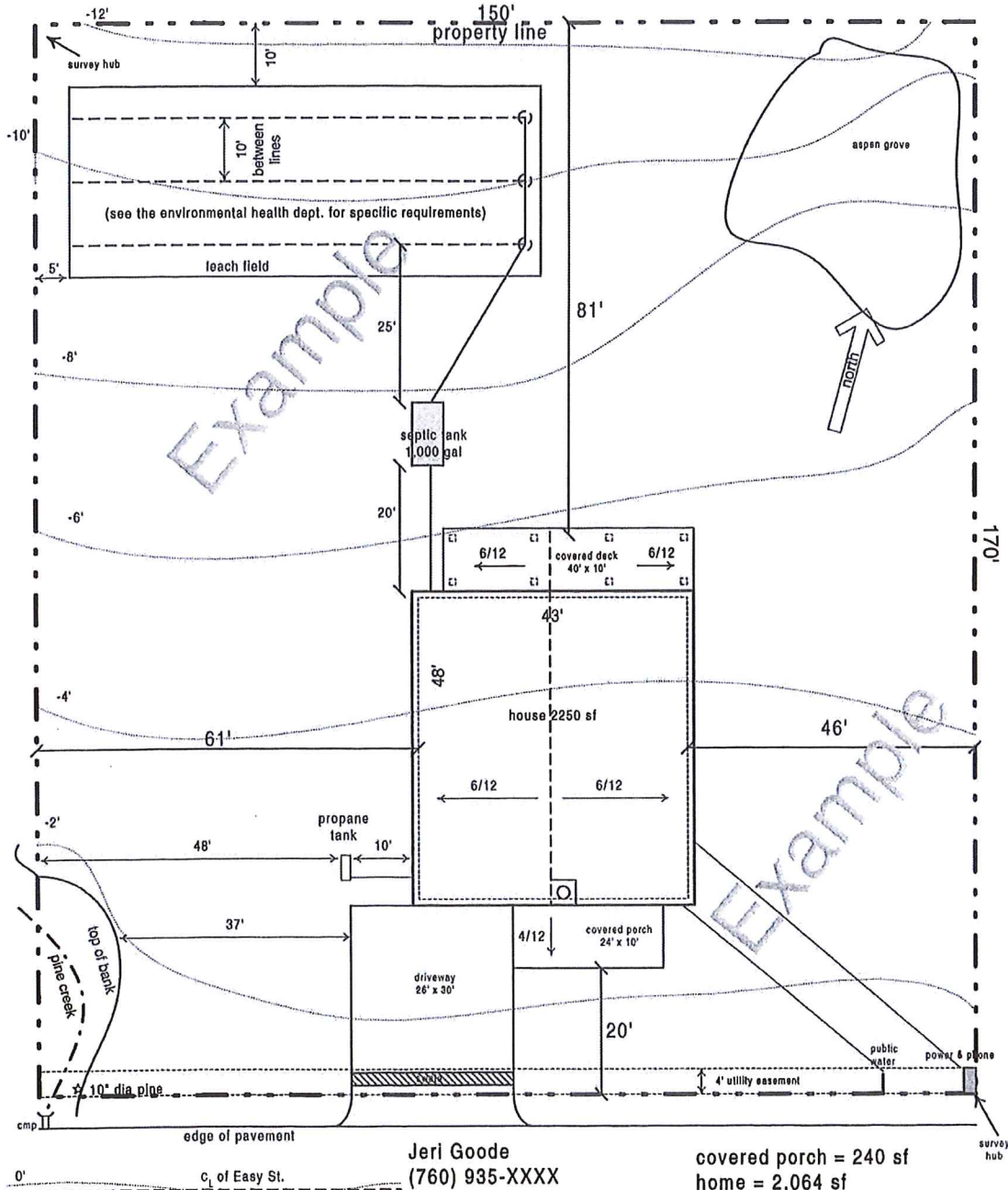

Jeri Goode
(760) 935-XXXX
123 Easy St.
Sunny Slopes, CA 93546
APN 62-XXX-XX
lot area = 25,500 sf
scale 1" = 20'

covered porch = 240 sf
home = 2,064 sf
covered deck = 400 sf
driveway = 780 sf
total lot coverage = 3,484 sf
or 13.6%

Page 5
version 1

**Mono County
Community Development Department**

PO Box 347
Mammoth Lakes, CA 93546
(760) 924-1800, fax 924-1801
commdev@mono.ca.gov

Planning Division

PO Box 8
Bridgeport, CA 93517
(760) 932-5420, fax 932-5431
www.monocounty.ca.gov

**DIRECTOR REVIEW
APPLICATION**

APPLICATION # _____	FEE \$ _____
DATE RECEIVED _____	RECEIVED BY _____
RECEIPT # _____	CHECK # _____ (NO CASH)

APPLICANT/AGENT Devin Valletta

ADDRESS 574 cypress hills dr CITY/STATE/ZIP encinitas CA. 92024

TELEPHONE (760) 8153375/ 9088218 E-MAIL Devin.Valletta3@gmail.com

OWNER, if other than applicant N/A

ADDRESS _____ CITY/STATE/ZIP _____

TELEPHONE (_____) _____ E-MAIL _____

DESCRIPTION OF PROPERTY:

Assessor's Parcel # 015-111-032-000 General Plan Land Use Designation mixed use

PROPOSED USE: Applicant(s) should describe the proposed project in detail, using additional sheets if necessary. Note: An incomplete or inadequate project description may delay project processing.

We will be utilizing half of our property for transient vacation rental (units A & C) and the other half long term rental keepin existing local tennants in place. Our intentions are to be concious of the local communities needs while also enabling short term rental availability which helps tourism and supports the local economy. We are utilizing the existing structure and making no changes to existiting structure interior as well as exterior. The only improvements would be standard up keep/ maintenance, Exterior repairs/ paint roof repairs, interior appliances paint and flooring.

I CERTIFY UNDER PENALTY OF PERJURY THAT I am: legal owner(s) of the subject property (all individual owners must sign as their names appear on the deed to the land), corporate officer(s) empowered to sign for the corporation, or owner's legal agent having Power of Attorney for this action (a notarized "Power of Attorney" document must accompany the application form), AND THAT THE FOREGOING IS TRUE AND CORRECT.



Signature

Signature

2.28.22
Date

**Mono County
Community Development Department**

PO Box 347
Mammoth Lakes, CA 93546
(760) 924-1800, fax 924-1801
commdev@mono.ca.gov

Planning Division

PO Box 8
Bridgeport, CA 93517
(760) 932-5420, fax 932-5431
www.monocounty.ca.gov

PROJECT INFORMATION

(To be completed by applicant or representative)

NOTE: Please answer all questions as accurately and completely as possible to avoid potential delays in processing. Attach additional sheets if necessary.

I. TYPE OF PROJECT (check any permit(s) requested):

- Director Review Use Permit Lot Line Adjustment Land Division (4 or fewer)
 Subdivision Specific Plan Variance General Plan Amendment
 Other _____

APPLICANT Devin Valletta

PROJECT TITLE short term rental for two units and maintaining the remaining units as long term rentals

LOT SIZE (sq. ft./acre) 10,000 ASSESSOR'S PARCEL # 015-111-032-000

PROJECT LOCATION 34 foster ave june lake

Has your project been described in detail in the project application? Yes No

Please Specify:

Number of Units 2 of 4 Building Height/# of floors 1 level
Number of Buildings 2 Density (units/acre) .21 acres

Total lot coverage/impervious surface (sq. ft. & %) _____
a. Buildings (first-floor lot coverage /sq. ft. & %) 3528 sqft
b. Paved parking & access (sq. ft. & %) 1965 sqft

Landscaping/screening and fencing:
a. Landscaping (sq. ft. & %) 2250 sqft
b. Undisturbed (sq. ft. & %) 2250 sqft

Total parking spaces provided:
a. Uncovered 9
b. Covered 0
c. Guest/Handicapped 1

II. SITE PLAN

Are all existing and proposed improvements shown on the Plot Plan (see attached Plot Plan Requirements)? Yes No

III. ENVIRONMENTAL SETTING

Use one copy of the Tentative Map or Plot Plan as needed to show any necessary information. Attach photographs of the site, if available.

More on back...

1. VICINITY MAP:
Attach a copy of assessor's parcel pages or a vicinity map showing the subject property in relation to nearby streets and lots or other significant features.

2. EXISTING DEVELOPMENT:
Vacant If the site is developed, describe all existing uses/improvements such as structures, roads, etc. Does the Plot Plan show these uses? Yes No
Structure is currently used as a rental property.

3. ACCESS/CIRCULATION:
Name of Street Frontage(s) _____
Paved Dirt No existing access
Are there any private roads, drives or road easements on/through the property?
Yes No
Has an encroachment permit been submitted to Public Works or Caltrans? Yes No
Does the property have any existing driveways or access points? Yes No
Are any new access points proposed? Yes No
Does the Plot Plan show the driveways or access points? Yes No
Describe the number and type of vehicles associated with the project _____

4. ADJACENT LAND USES:
A. Describe the existing land use(s) on adjacent properties. Also note any major man-made or natural features (i.e., highways, stream channels, number and type of structures, etc.).

<u>LAND USE</u>	<u>LAND USE</u>
North <u>residential</u>	South <u>residential</u>
East <u>residential</u>	West <u>residential</u>

B. Will the proposed project result in substantial changes in pattern, scale or character of use in the general area? Yes No If YES, how does the project propose to lessen potential adverse impacts to surrounding uses? _____

5. SITE TOPOGRAPHY:
Is the site on filled land? Yes No Describe the site's topography (i.e., landforms, slopes, etc.) N/A

6. DRAINAGES:
A. Describe existing drainage ways or wetlands on or near the project site (i.e., rivers, creeks and drainage ditches 12" or deeper and/or within 30' of the property) _____
N/A

- B. Are there any drainage easements on the parcel? Yes No

- C. Will the project require altering any streams or drainage channels? Yes No If YES, contact the Department of Fish and Game for a stream alteration permit. IF YES TO ANY OF THE ABOVE, show location on plot plan and note any alteration or work to be done within 30 feet of the stream or drainage.

7. VEGETATION:
A. Describe the site's vegetation and the percentage of the site it covers (map major areas of vegetation on the Plot Plan) vegetation is composed of short bermuda grass and light shrubs. 0

B. How many trees will need to be removed? 0

C. Are there any unique, rare or endangered plant species on site? Yes No

D. Has the site been used for the production of agricultural crops/trees or grazing/pasture land in the past or at the present time? Yes No

E. Is landscaping/planting of new vegetation proposed? Yes No

8. WILDLIFE:

A. Will the project impact existing fish and wildlife? Yes No

Describe existing fish and wildlife on site and note any proposed measures (if any) to avoid or mitigate impacts to fish and wildlife _____

B. Are there any unique, rare or endangered animal species on site? Yes No

9. CULTURAL RESOURCES:

A. Are there any cemeteries, structures or other items of historical or archaeological interest on the property? Yes No Specify Unknown _____

10. SITE GRADING:

A. Will more than 10,000 square feet of site area be cleared and/or graded?

Yes No If YES, how much? _____

B. Will the project require any cuts greater than 4' or fills greater than 3'? Yes No

C. Will the project require more than 200 cubic yards of cut or fill? Yes No If YES, how much? ____ If YES to A, B or C, contact the Department of Public Works for a grading permit.

D. Will site grading of 10% or more occur on slopes? Yes No

E. Note any measures to be taken to reduce dust, prevent soil erosion, or the discharge of earthen material off site or into surface waters N/A _____

11. AIR QUALITY:

A. Will the project have wood-burning devices? Yes No If YES, how many? 4 now

B. What fuel sources will the proposed project use? Wood Electric Propane/Gas

C. Will the proposal cause dust, ash, smoke, fumes or odors in the vicinity? Yes No

12. VISUAL/AESTHETICS:

A. How does the proposed project blend with the existing surrounding land uses? utilizing the existing structure no exterior or interior structural changes _____

B. How does the proposed project affect views from existing residential/commercial developments, public lands or roads? not affected _____

C. If outdoor lighting is proposed, describe the number, type and location _____
N/A

13. NATURAL HAZARDS:

A. Is the site known to be subject to geologic hazards such as earthquakes, landslides, mudslides, ground failure, flooding, avalanche or similar hazards? Yes No
(Circle applicable hazard[s]).

B. Will any hazardous waste materials such as toxic substances, flammables or explosives be used or generated? Yes No

C. Does the project require the disposal or release of hazardous substances? Yes No

D. Will the project generate significant amounts of solid waste or litter? Yes No

E. Will there be a substantial change in existing noise or vibration levels? Yes No
If YES to any of the above, please describe _____

14. OTHER PERMITS REQUIRED:

List any other related permits and other public approvals required for this project, including those required by county, regional, state and federal agencies:

- Encroachment Permits from *Public Works or Caltrans*.
- Stream Alteration Permit from *Department of Fish and Game*
- 404 Wetland Permit from *Army Corps of Engineers*
- Grading Permit from *Public Works*
- Building Permit from *County Building Division*
- Well/Septic from *County Health Department*
- Timber Land Conversion from *California Department of Forestry*
- Waste Discharge Permit from *Lahontan Regional Water Quality Control Board*
- Other _____

IV. SERVICES

1. Indicate how the following services will be provided for your project and the availability of service.

Electricity _____

Underground Overhead (Show location of existing utility lines on Plot Plan)

Road/Access snow removal on site

Water Supply Municipal

Sewage Disposal standard

Fire Protection existing

School District N/A

2. If an extension of any of the above is necessary, indicate which service(s), the length of extension(s), and the infrastructure proposed N/A

CERTIFICATION: I hereby certify that I have furnished in the attached exhibits the data and information required for this initial evaluation to the best of my ability, and that the information presented is true and correct to the best of my knowledge and belief. I understand that this information, together with additional information that I may need to provide, will be used by Mono County to prepare a Specific Plan in compliance with state law.

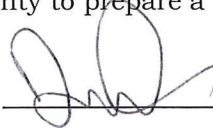
Signature  Date 2-28-22

For _____

NOTE: Failure to provide any of the requested information will result in an incomplete application and thereby delay processing.